

Tess 440

Wire guided tension blind

- Automated, retractable sun screening system
- Suitable for vertical and horizontal external applications
- Maximum daylight under dull conditions
- Reduced heat gain and glare on sunny days
- Integrated radio control operation
- Wireless connection to sun and wind controls (optional)



Application

The TESS range of shading systems has been developed to satisfy the demand for retractable sun screening on horizontal and sloping glazing. They are designed primarily for commercial buildings such as offices, shops, hotels and airports as well as glazed structures such as conservatories, winter gardens and restaurants.

Control

Each unit has a built in Simu motor with the option of an integrated radio control for convenience in operation and simplified wiring. Group and automatic sun and/or wind control are available on all systems. If the wind speed exceeds 11 m/s the blinds should be fully retracted.



Operation

The TESS 440 tension blind mechanism is suitable for rectangular fabric shades which are installed externally in front of or above the glazing. It can also be used for vertical applications where the fabric is pulling up from the bottom.

The fabric is held under tension through-out its travel and can be stopped in any position. A stainless steel wire acts as both a guide and a restraint for the aluminium hem bar and eliminates the need for relieving rollers or other forms of intermediate fabric support.



Assessed to ISO 9001: 2000
Certificate No 193

Guthrie Douglas

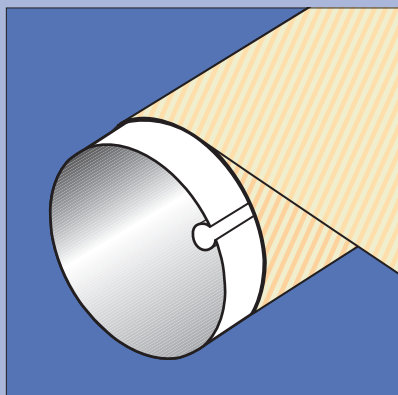

Fabric roller

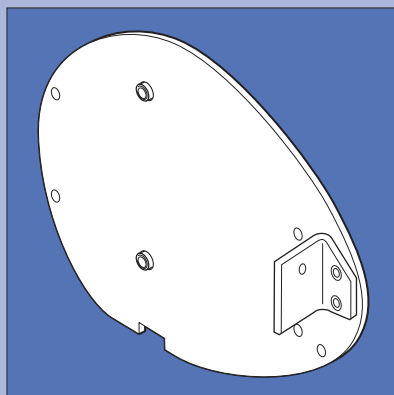

Roller end plate

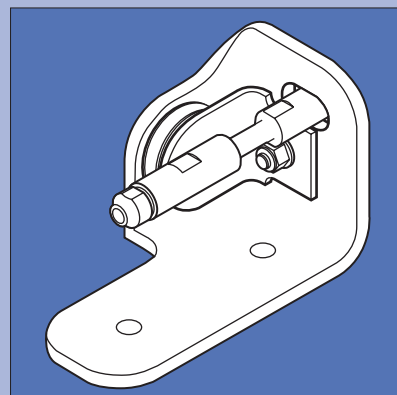

Return pulley bracket (single)

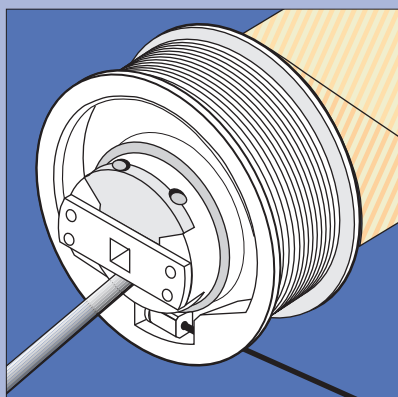
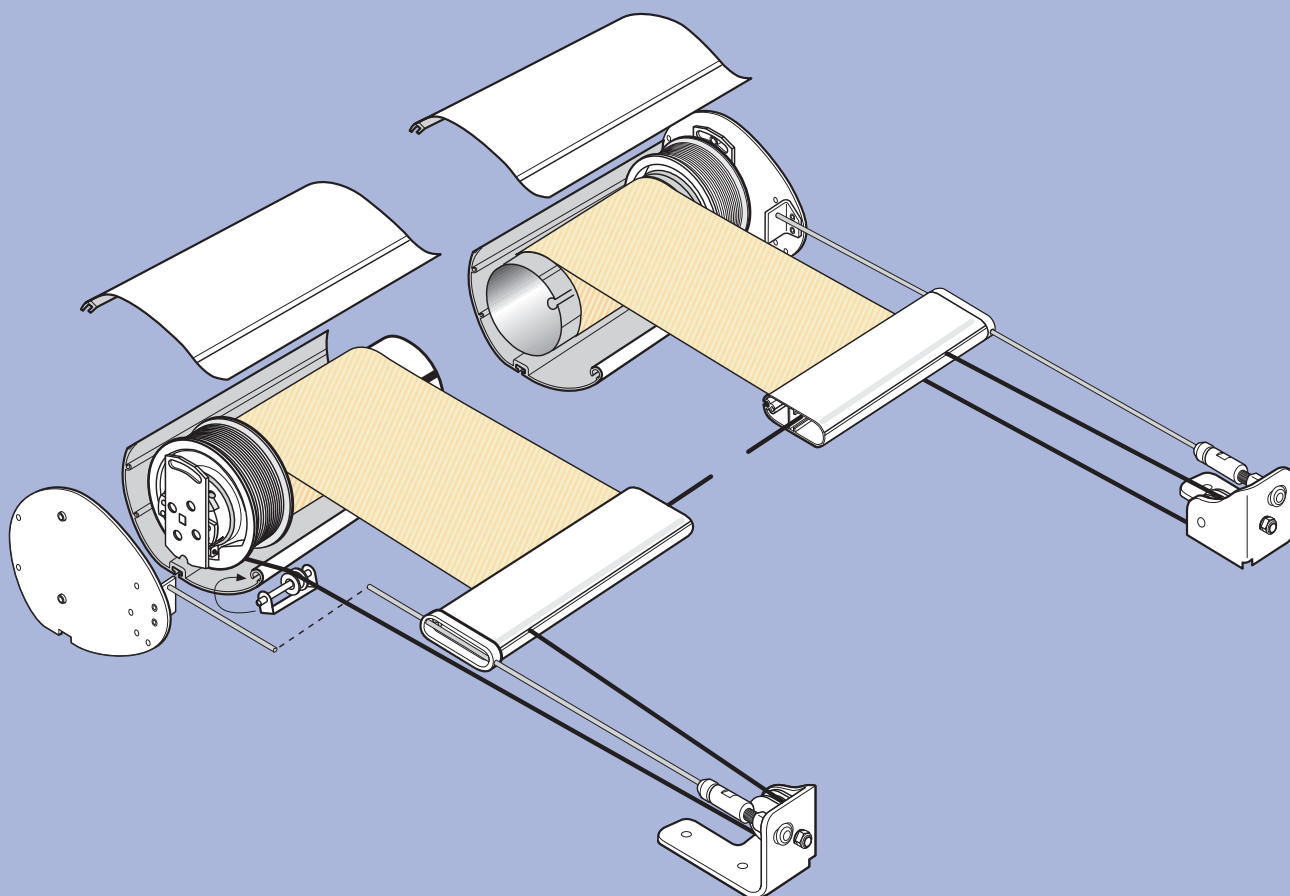

Motor with cable spool
(without mounting plate)

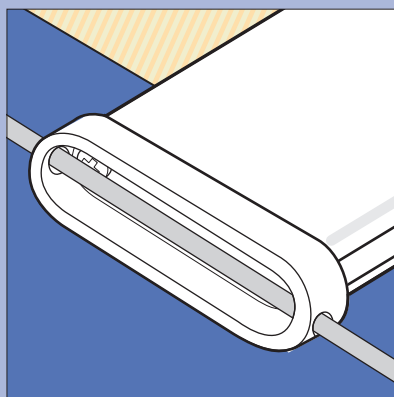

Hem bar end cap

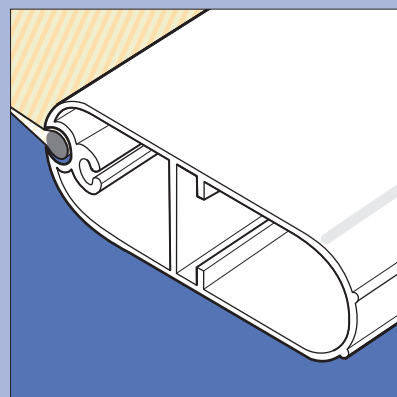

Hem bar

Tension blind system comprising:

- A single 85mm galvanised steel roller incorporating both the drive motor and the spring compensation cassette with integral tension adjustment gear
- Extruded aluminium hem bar supporting the free end of the fabric carried by two 5mm dia stainless steel cables
- A continuous nylon coated tension cable to deploy and retract the blind by means of two 6.5m capacity cable drums, one on either end of the fabric roller

Finishes

- Aluminium components finished in the standard polyester powder finish, 30% gloss
- Fasteners of stainless steel and other steel parts galvanised against corrosion

Installation

- Available with either single or back-to-back return pulley brackets or a face fix bracket

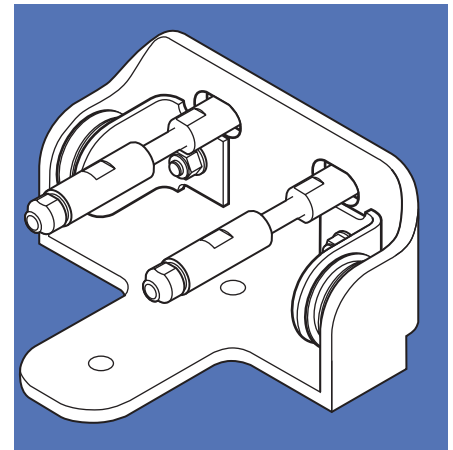

Back to back return pulley option

Technical Data

System dimensions:

Max. recommended width 4m

Maximum draw 6.5m

Maximum fabric area 16m² (based on a fabric weight of 450g/m²)

Motor

Torque 15Nm at 17rpm

Current 0.6amps

Supply 230 v AC single phase

Other voltages and frequencies available on request

System weights and structural loading

Base weight for a 1m wide system - 15Kg, additional metre width – 5Kg

Load created by fabric tension & guide wire - 100Kg per anchor point

Wind speed 11 metres/second max.

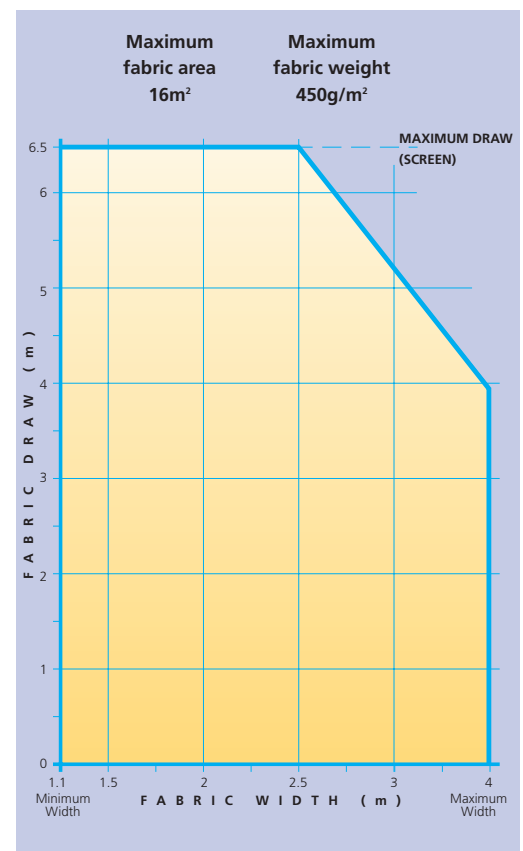

Single System

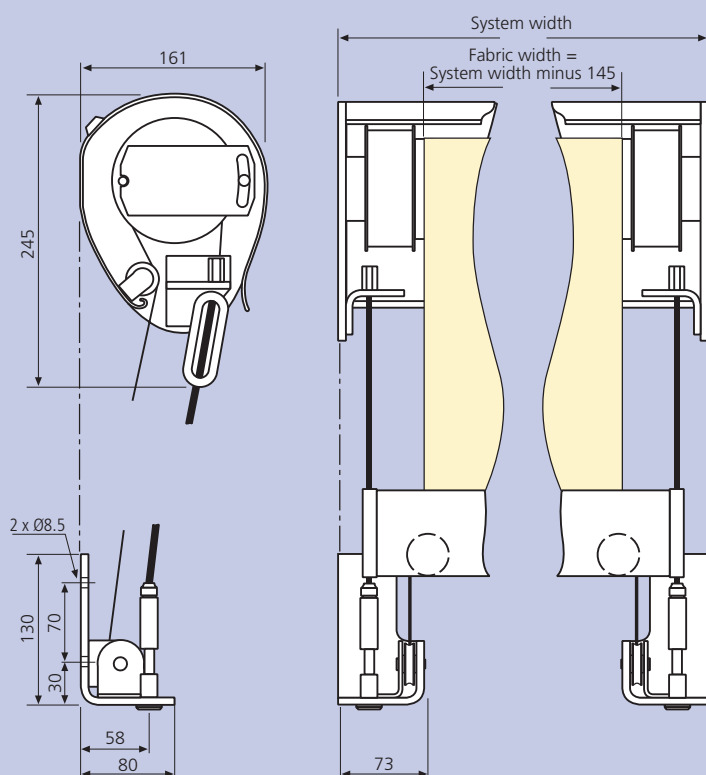

Back to Back

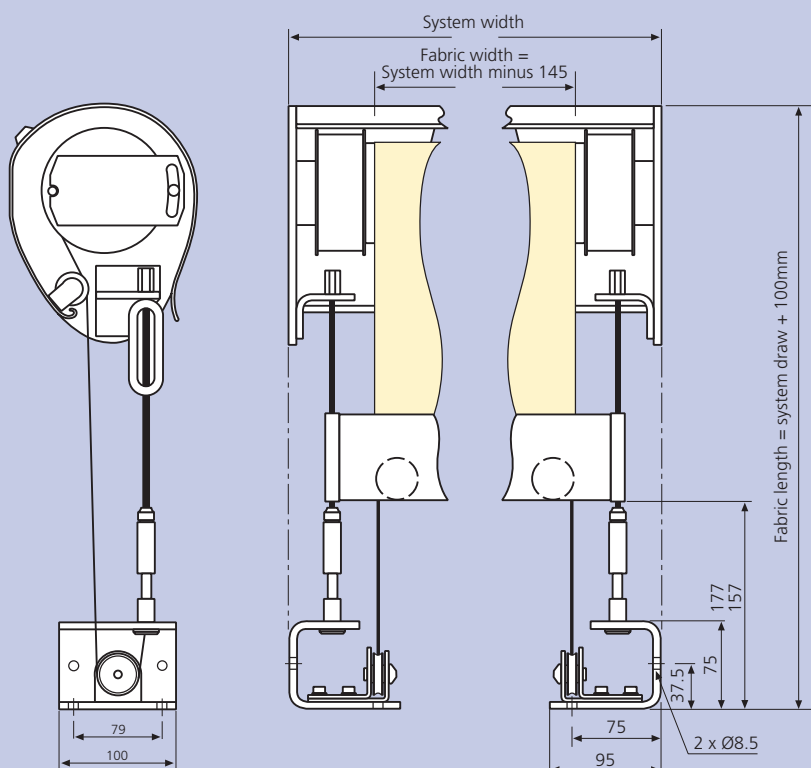
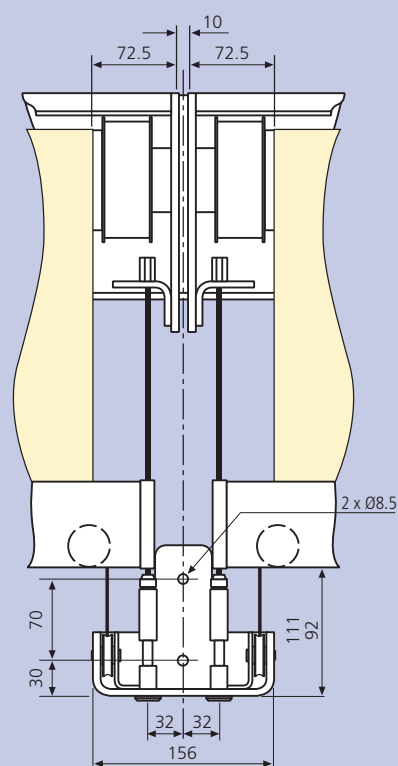
Face Fix Return
Pulley Installation

Guthrie Douglas

Guthrie Douglas Limited

12 Heathcote Way, Heathcote Industrial Estate
Warwick, UK CV34 6TE

Telephone: (+44) 01926 452 452 Fax: (+44) 01926 832 914

E-mail: sales@guthriedouglas.com Web site: www.gdsolarcontrol.com